



**VIKING**  
AIRPORT EQUIPMENT

Email: [sales@vikingltd.aero](mailto:sales@vikingltd.aero)

Phone: +44 (0) 1706 875 139

<https://www.viking-ltd.com>

MANUFACTURERS OF CARGO AND AIRPORT HANDLING EQUIPMENT

## **PALLET DOLLIES: PD44R & PD84**



**PD44R – WIDE END TOW  
ROLLER DECK (SIDE LOADING)**



**PD84 – NARROW END TOW CASTOR  
DECK (SIDE & REAR) LOADING**

The pallet dollies are designed and manufactured by our team at Viking to meet current IATA, BS and European standards. The one piece welded construction chassis offers a light but very robust structure, with a pressed steel fabrication to provide the ability to withstand the daily rigours of an airport environment.

Both pallet dolly variants have a top deck height of 508mm (20") and are fitted with a parking brake to inboard drum wheel hubs that are activated upon lifting the tow bar vertically. Turn table steer, over-run brakes, anti step over barrier, and auto reverse braking systems are available as optional extras.

The chassis is galvanised and utilises the wind catcher finger stops (for upward and lateral restraint) as standard to ensure all pallets / ULD are secure during transportation. Vikings pallet dolly design provides maximum stability for the movement of various ULD and pallets around the airport apron.

The pallet dollies are capable of handling the following pallets/ULD: 125" x 96" or 125" x 88" or 108" x 88" or 2 x LD1 or 2 x LD3

## Technical Specification

**Approximate Size:** 3350mm (132") x 2700mm (106")

**S.W.L.:** 7000Kg

**Chassis:** All pressed steel construction, fully welded with some use of RHS and RCS where necessary

**Wheels:** 8 Viking solid SUPA cushion tyres

**Deck:** Utilises inverted 96mm top deck toe guarded castors  
**Steering:** Via turntable steering as standard, Swivel castor steering option available.

**Finish:** Galvanised to BS EN ISO 1461

- Fork pocket interface for health and safety compliance for service on the apron environment
- 508mm Deck Height with total deck infill up-form
- Non-slip HSE compliant as standard
- Twin wheeled rocking axle bogies unbraked to the rear
- Park brake to front bogies when tow bar is raised
- Fixed front headboard with leading edge flares to ease pallet loading
- Viking standard wind catcher lift-up finger stops to contain standard Pallets / ULD's
- Viking standard forged 76mm or 50mm diameter NATO tow eye spring loaded
- Viking delta shaped pressed steel tow bar
- Viking standard spring loaded E-Type rear tow hitch type
- Day-glow paint to all corners and reflective hazard tape to sides and rear

## Options & Upgrades Available

Swivel castor steering mechanism

Over-Run Brake mechanism

Auto Reverse Brake System

Wide / Narrow End Tow

50m Tow Eye

Transfer Trailer interface

Anti Step Over Barrier



# PD44R

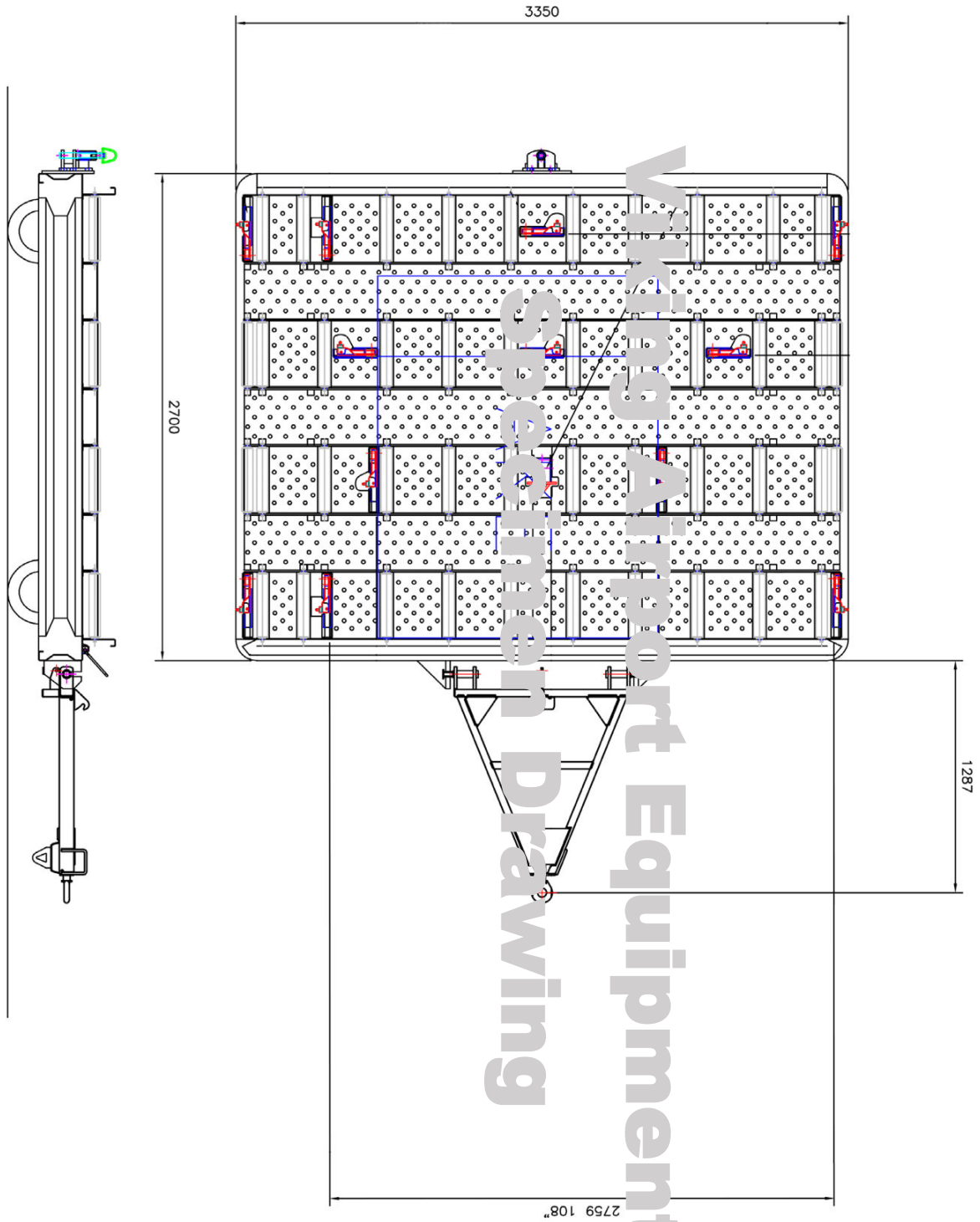

# PD84

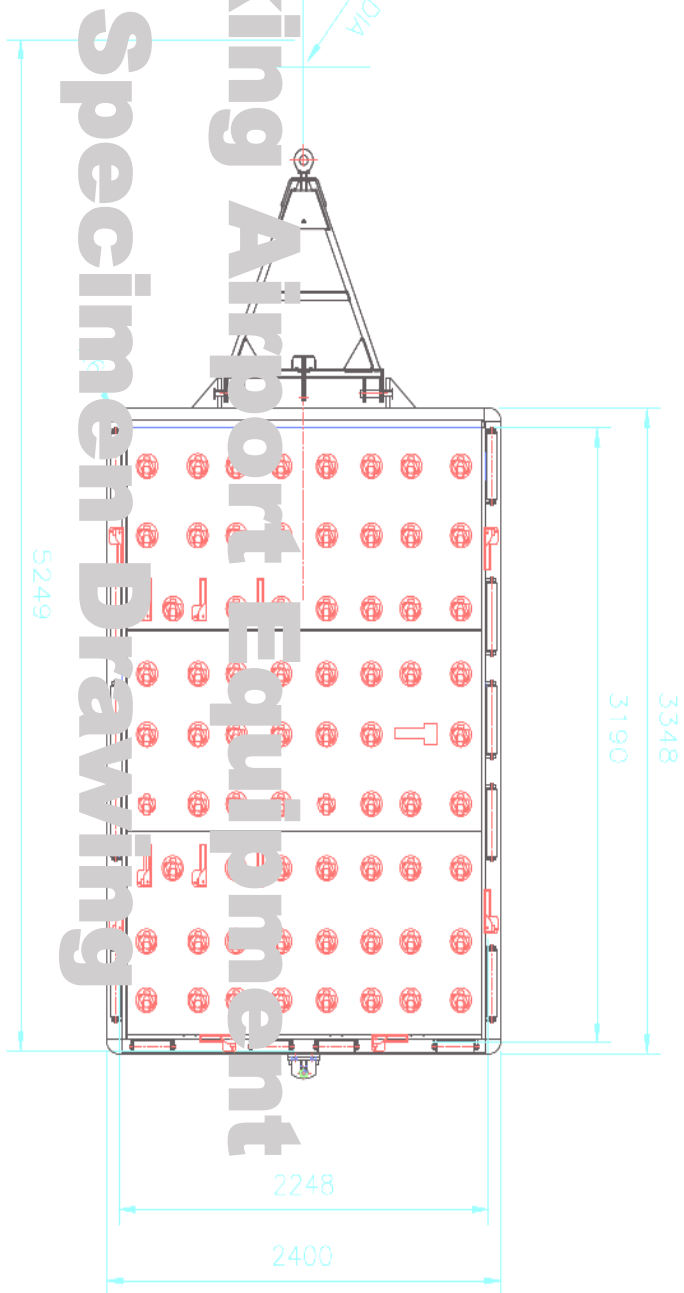
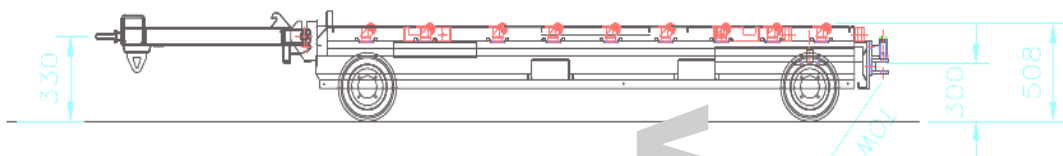

Viking Airport Equipment  
Specimen Drawing